



277 Mortimer Road

, South Shields, NE34 0DR

£265,000



In a great location with good transport routes and schools nearby, delighted to offer this larger style Semi Detached Home with garage and generous drive. The home offers the family buyer the chance to alter and upgrade yet comes with gas central heating good double glazing, a kitchen diner, three bedrooms and a large bathroom with corner bath and separate shower enclosure. Outside there are gardens to both front and rear, the garage and a workshop/man cave. No Onward Chain, viewing a must. EPC



Entrance Porch

Tiled floor

Entrance Hall

Stairs to the first floor, radiator

Cloaks WC

Wash basin and WC

Living Room 14'0" x 10'10" (4.28 x 3.32)

Wall mounted gas fire, bay window and radiator

Sitting Room 13'1" x 12'9" (4.00 x 3.90)

stone fireplace with bespoke alcove fitted units, gas fire, radiator

Kitchen diner 21'9" x 10'3" (6.63 x 3.14)

fitted with a range of wall, base units and work surfaces housing a sink unit, AEG electric hob, Bosch oven and grill, wall mounted central heating boiler, breakfast bar and a radiator

Utility 13'3" x 9'8" (4.04 x 2.96)

to the side of the home with storage space and plumbing for a washer, tiled floor

First Floor

landing

Bedroom 1 12'5" x 9'1" (3.80 x 2.77)

Bay window, fitted wardrobes and storage, two radiators

Bedroom 2 13'8" x 12'5" (4.18 x 3.81)

fitted wardrobes and storage, desk unit, vanity wash basin, radiator

Bedroom 3 7'8" x 7'8" (2.35 x 2.35)

Shelving unit, radiator

Bathroom

Corner bath, wash basin and WC, separate shower enclosure with mixer shower, tiled and clad walls, towel radiator

Garage

A single garage with up and over door

External

Block paved double drive, lawned front garden. To the rear are enclosed paved gardens with a workshop/man cave with power.

Area Map



Floor Plans

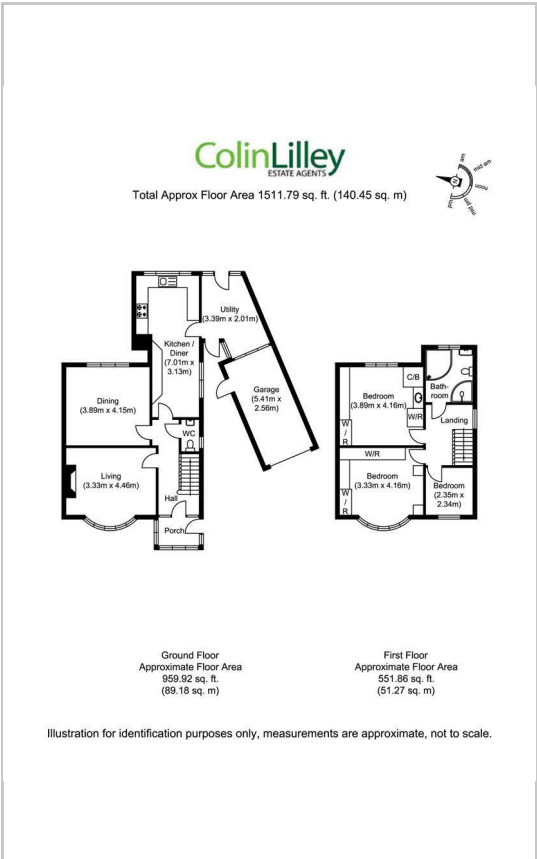

Energy Efficiency Graph

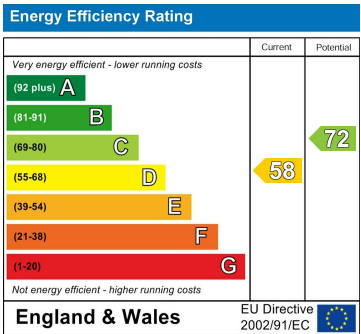

These particulars, whilst believed to be accurate are set out as a general outline only for guidance and do not constitute any part of an offer or contract. Intending purchasers should not rely on them as statements of representation of fact, but must satisfy themselves by inspection or otherwise as to their accuracy. No person in this firm's employment has the authority to make or give any representation or warranty in respect of the property.